

MODEL AFM3000

The AFM Airflow Monitor connects directly to the AccuValve Model AVT3000 / H-AVT3000 to provide a local airflow volume display. The AFM3000 is offered with standard cable lengths up to 100' to ensure the AFM3000 can be mounted in a convenient location that is easily accessible. The AFM3000 is provided with 2 mounting screws for securing to a standard single-gang electrical box.

AFM3000-

CABLE LENGTH

- 25' Cable = **025**
- 50' Cable = **050**
- 75' Cable = **075**
- 100' Cable = **100**

NOTE: If a longer cable is required, please contact factory.

SPECIFICATIONS

Electrical:

The AFM3000 is powered by the AccuValve AVT using a factory provided cable.

Temperature Range:

- Operating: -4°F to +158°F (-20°C to +70°C)
- Storage: -22°F to 176°F (-30°C to +80°C)

Physical Construction:

Metal plate with a black powder coating.

Mounting:

Installs directly into a standard single-gang electrical box.

Configuration Port:

Easily accessible USB Mini Type B protected by removable rubber plug.

INSTALLATION

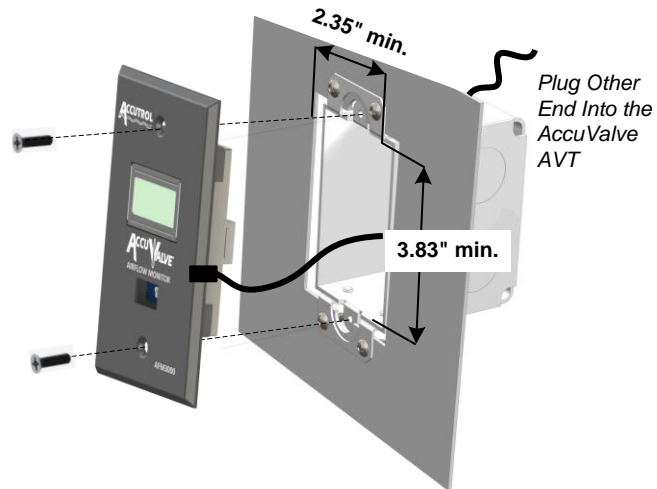

1. Feed the display cable thru the back of the electrical box.
2. Plug one end of the display cable into the RJ-45 connector located on the back of the AFM3000.
3. Plug the other end of the cable into the AccuValve Display Port.
4. Secure the AFM3000 to the electrical box using the two screws provided.

DIMENSIONS

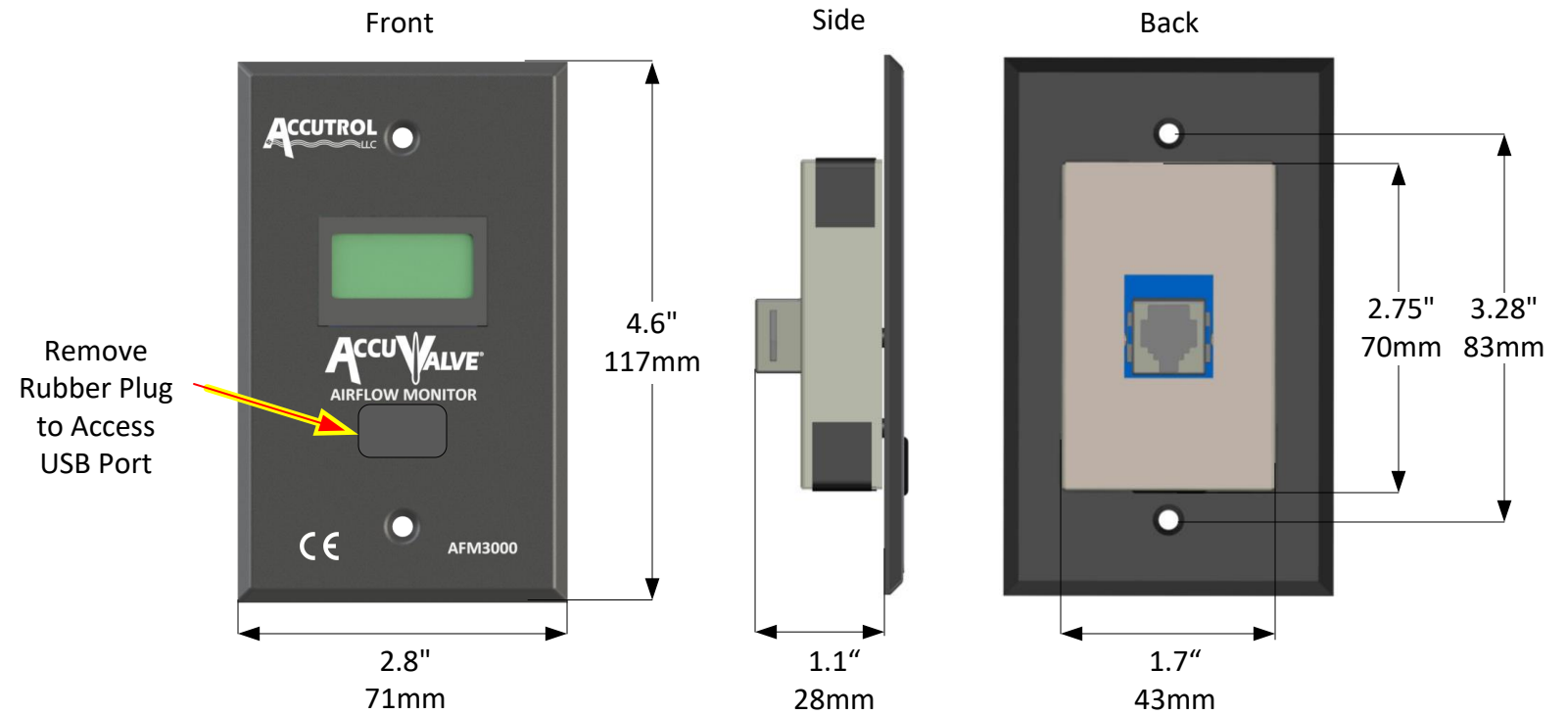

APPLICATION

Detail shown with standard transmitter enclosure

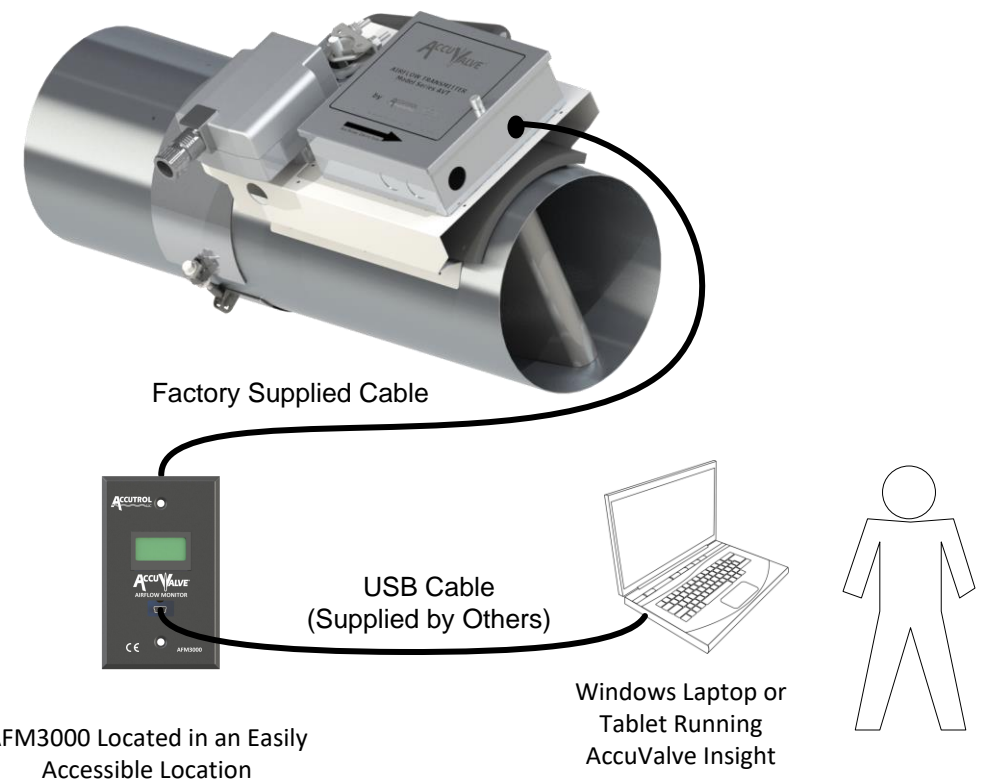

DWG. NO:	AFM3000 SUBMITTAL DWG		
REVISION:	A	ECN:	2337
REV. DATE:	2-6-17	SHEET:	1 OF: 1